

SEAL:

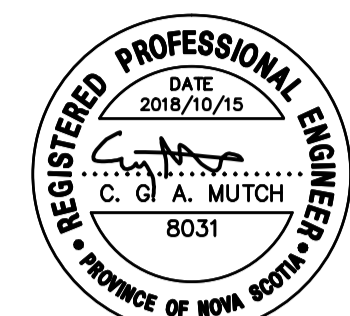

KEY PLAN:

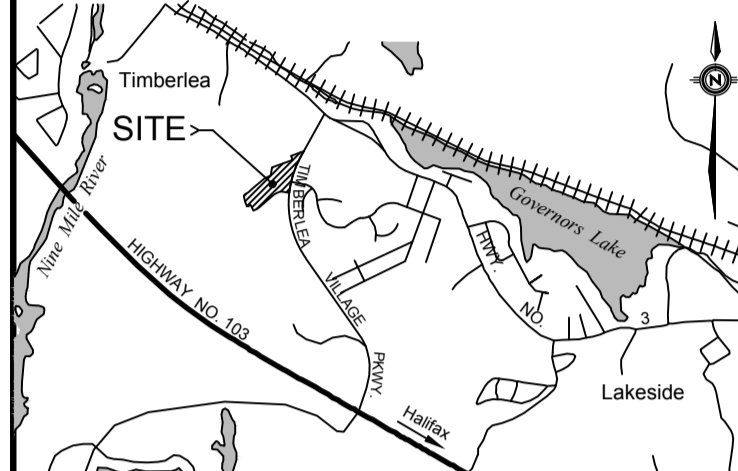

LEGEND:

	CONSTRUCTED	PRE-EXISTING
EDGE OF PAVEMENT		
LOTLINE		
WATERMAIN & GATE VALVE		
SANITARY PIPE & MANHOLE		
STORM PIPE & MANHOLE		
UTILITY LINES & POLE		
STREET BOUNDARY		
PROPERTY BOUNDARY		
EASEMENT		
CURB & DRIVEWAY CUT		
CATCH BASIN		
FIRE HYDRANT		
STREET TREE		
ROAD SIGN		
SANITARY LATERAL		
STORM LATERAL		
WATER LATERAL		
CATCH BASIN LEAD		
ENDCAP		
CULVERT		
HEADWALK		
SIDEWALK		
FENCE		

DISCLAIMER: DRAWINGS ARE PRELIMINARY AND ARE SUBJECT TO APPROVAL PRIOR TO CONSTRUCTION. THIS DRAWING AND DESIGN IS COPYRIGHT PROTECTED WHICH SHALL NOT BE USED, REPRODUCED OR REVISED WITHOUT WRITTEN PERMISSION BY WSP CANADA INC. THE CONTRACTOR SHALL CHECK AND VERIFY ALL DIMENSIONS AND UTILITY LOCATIONS AND REPORT ALL ERRORS AND OMISSIONS PRIOR TO COMMENCING WORK. SEE SHEET 11 FOR CONSTRUCTION NOTES AND DETAILS.

REVISION:

NO.	DATE	DESCRIPTION
11	2018/10/15	RECORD DRAWING
10	2018/04/04	REVISIONS FOR APPROVED LIGHT DESIGN
9	2018/03/21	ISSUED FOR CONSTRUCTION
8	2018/02/26	REVISED LOTS 216-232, PRIMARY POWER
7	2013/07/22	2017/10/27 VARIOUS REVISIONS
6	2012/12/21	ISSUED FOR REVIEW

PROJECT NO.:

121-24187	DATE: (YYYY/MM/DD) 2012/12/21
ORIGINAL SCALE: HORIZONTAL: 1:500 VERTICAL: N/A	IF THIS BAR IS NOT 25mm LONG, ADJUST YOUR PLOTTING SCALE.
DESIGNED BY: G. O'BRIEN, P.ENG.	
DRAWN BY: D. LONGMUIR	
CHECKED BY: C. MUTCH, P.ENG.	

SCALE: 1:500 METRIC

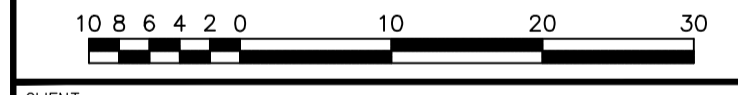

CLIENT:

BRUNELLO ESTATES INC.

CLIENT REF. #:



TITLE:

**TIMBERLEA VILLAGE PARKWAY
TURNING LANES 1**

SHEET NUMBER:

8

ISSUE:

RECORD DRAWING

DATE OF: 2018/10/15

REV # **11**

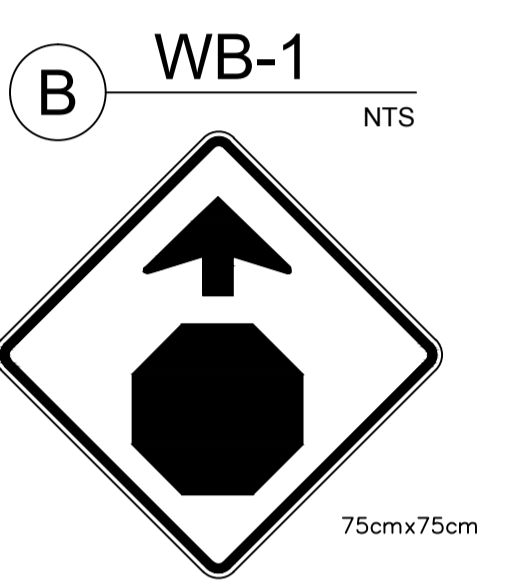
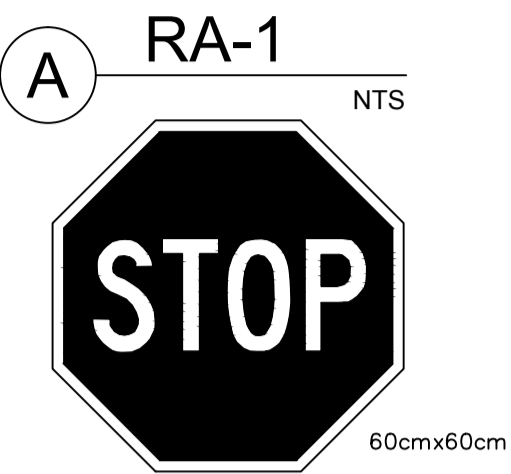
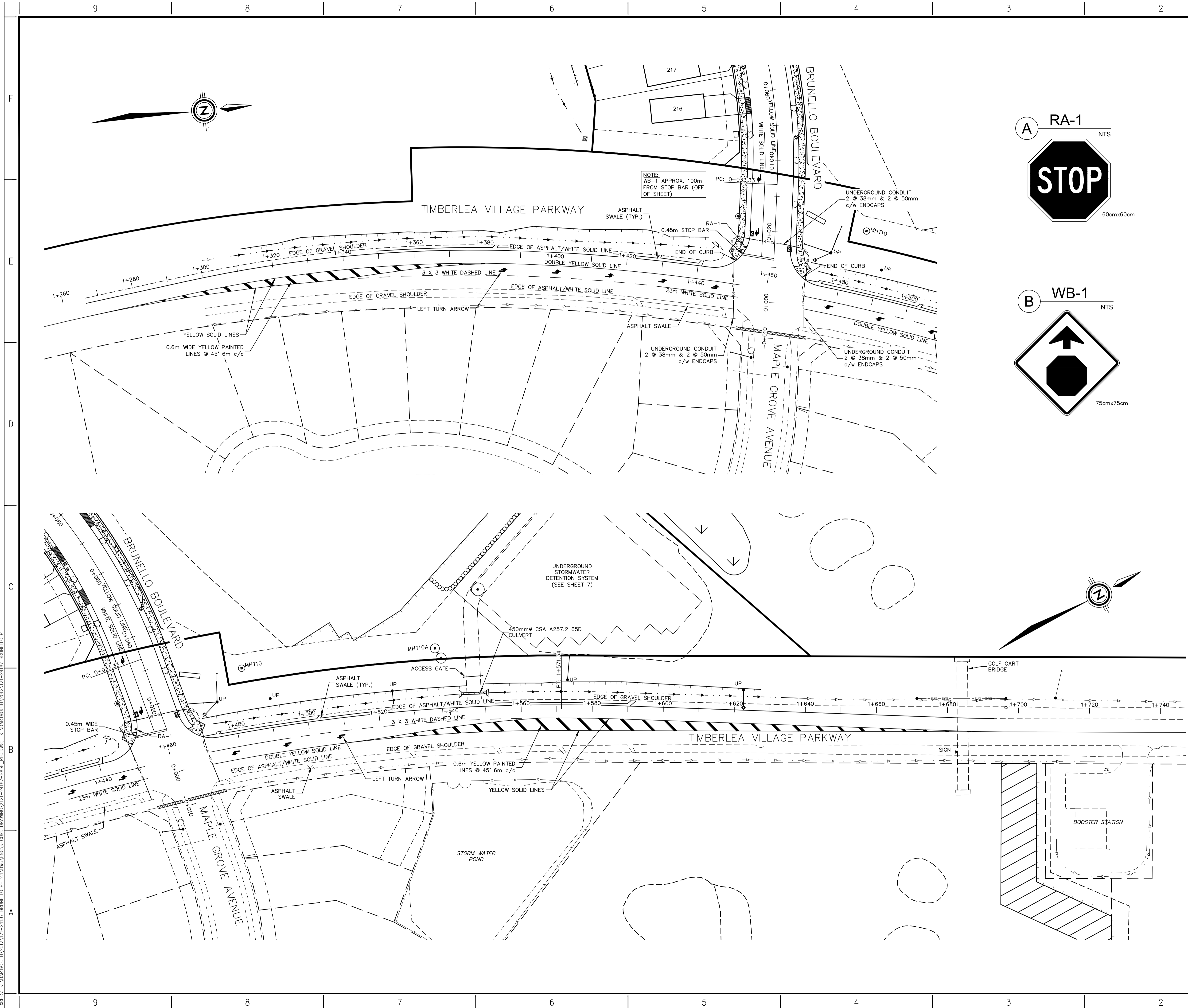

XREFS: K:\DARTMOUTH\2012\21-24187-BRUNELLO PH 2\DWG\ENG\RECORD DRAWING\21-24187-TVP-REC.DWG - K:\DARTMOUTH\2012\21-24187-BRUNELLO PH 2\DWG\ENG\RECORD DRAWING\21-24187-TVP-REC.DWG BY: CRAIG.LUTZ PRINTED: 8:56 AM 2018/10/15

XREFS: K:\DARTMOUTH\2012\21-24187-BRUNELLO PH 2\DWG\ENG\RECORD DRAWING\21-24187-TVP-REC.DWG - K:\DARTMOUTH\2012\21-24187-BRUNELLO PH 2\DWG\ENG\RECORD DRAWING\21-24187-TVP-REC.DWG BY: CRAIG.LUTZ PRINTED: 8:56 AM 2018/10/15